

Multimedia filters WTX series



APPLICATIONS: Energy/ Power, Food and Beverage Industry, Healthcare, Pharmaceutical, Municipal drinking water, Wastewater treatment

USAGE: Filters of this series could be used for the removal of suspended solids from the water, the removal of color, odor and organic contaminants, the removal of iron and manganese, heavy metals (arsenic), as for the neutralization of pH. These filters could be used either individually, or as pretreatment in water treatment and desalination plants.

OPERATION: The water is filtered as it passes through a uniform porous media from top to bottom. Particulate matter is entrapped between the pores of the media where is flushed out by reversing the flow. Backwash flow fluidizes the media and removes the accumulated particles.

Materials

BODY: Steel S235JR (also available in stainless steel AISI 304 & 316, upon request)

GASKETS: EPDM

SURFACE TREATMENT: Chemical cleaning (pickling, phosphate) and electrostatic painting with polyester powder (available epoxy coatings suitable for drinking water).

Single System

CODE	05-17-152	05-17-202	05-17-204	05-17-300	05-17-360	05-17-480	05-17-338	05-17-483
DESCRIPTION	1 ½''-18''	2''-20''	2''-24''	2''-30''	2''-36''	2''-48''	3''-36''	3''-48''
FILTRATION AREA (m ²)	0.16	0.20	0.28	0.44	0.63	1.13	0.63	1.13
NOMINAL FLOW RATE (m ³ /h) *	9	11	15	25	35	62	35	62
H (mm)	1500	1500	1500	1500	1500	1500	1500	1500
L1 (mm)	380	370	400	450	450	650	450	650
L2 (mm)	1300	1300	1300	1300	1300	1300	1300	1300
Ø D (mm)	450	500	600	750	900	1200	900	1200
WEIGHT (kg)	71	109	130	167	213	394	216	400
TANK VOLUME (Lt)	260	330	475	750	1130	2080	1130	2080

* CALCULATED ON FILTRATION SPEED 55 (m/h) per 1 square meter of filter, which is the average recommended filtration speed for most applications. However, each design must consider its specific requirements for water quality.

Duplex System

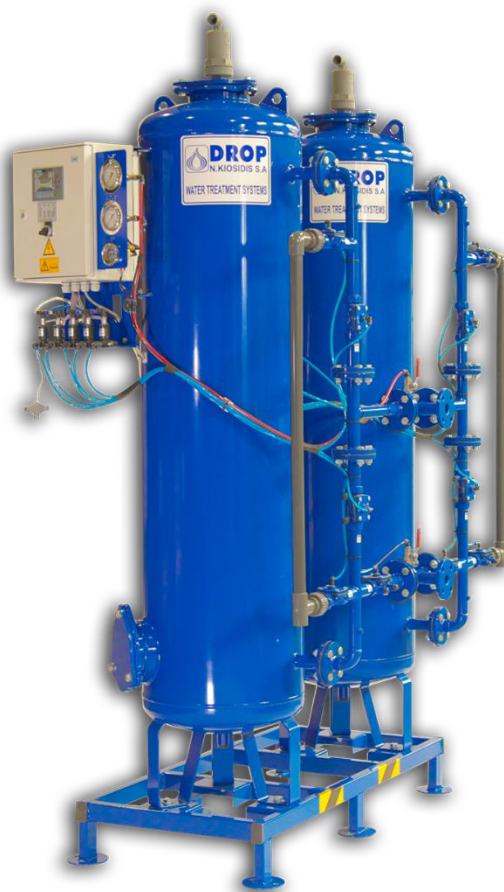

Duplex media filter is used as:

- Twin alternating operation where 1 of the two tanks is on duty and the other is stand by.
- Parallel duplex operation which is recommended for high flows requirements.

CODE	05-18-152	05-18-202	05-18-204	05-18-300	05-18-360	05-18-480	05-18-338	05-18-483
DESCRIPTION	1 ½''-18''	2''-20''	2''-24''	2''-30''	2''-36''	2''-48''	3''-36''	3''-48''
FILTRATION AREA (m ²)	0.32	0.40	0.56	0.88	1.26	2.26	1.26	2.26
NOMINAL FLOW RATE (m ³ /h) ***	17	21	30	48	70	122	70	122
H (mm)	1500	1500	1500	1500	1500	1500	1500	1500
L1 (mm)	380	370	400	450	450	650	450	650
L2 (mm)	1300	1300	1300	1300	1300	1300	1300	1300
Ø D (mm)	450	500	600	750	900	1200	900	1200
WEIGHT (kg) *	170	249	294	371	466	832	472	844
TANK VOLUME (Lt)	560	660	950	1500	2260	4160	2260	4160

*Weight calculated with the base

Media

DESCRIPTION	GRAIN SIZE	PACKING	PROPERTIES	ILLUSTRATION
Gravel EN 12904	3.15-5.6 mm	25 kg (bag)	- Support layer	
Silica sand EN 12904	1.0-2.0 mm	25 kg (bag)	- Suspended solid removal	
	0.8-1.2 mm			
	0.4-0.8 mm			
Anthracite EN 12909	0.8-1.6 mm**	50 L (bag)	- Turbidity - Suspended Solid Removal	
Activated carbon EN 12915	8 x 30 mesh**	25 kg (bag)	- Taste removal - Odor removal - Organic particles removal	
Pyrolusite EN 13572	0.3-0.8 mm**	25 kg (bag)	- Iron removal - Manganese removal	
Ferric Hydroxide EN 15029	0.2-2.0 mm	30 kg (drum)	- Arsenic removal	
Calcium Carbonate EN 1018	1.0-8.0 mm **	25 kg (bag)	- Remineralization - Deacidification - Increase pH - Iron-Manganese removal	
Almandite	0.2-0.6 mm **	25 kg (bag)	- Suspended solid removal down to 1µm - Polishing	
Dolomite	0.5-1.2 mm **	25 kg (bag)	- Drinking water purification - After RO application - Increase pH	
Recycling glass	0.5- 1.0 mm**	25 kg (bag)	- Drinking water purification - Industrial liquid process - Dissolved organic removal	

** Available in other grain sizes

*** The actual flow rate is highly dependable on the quality of the water and the choice of the media. Most of the times the actual flow rate is 30-50% lower than the nominal flow rate.

For more information regarding the variety of the media and the relative flow rates, please contact us!

05-17-152A

ITEM	QTY	PART NUMBER	TITLE
1	1	02-00-836-18-000	Filter housing WTX 1 ½ " -18" (450*1500)
2	1	02-03-107	Collector 2" MS06 (PP)
3	6	02-03-118	Diffuser PP L 144xM30 slot 0.5 for filter X-1½"-18"
4	6	02-10-311	Nut M12x17 galvanized
5	6	02-10-250	Washer M12 DIN 125
6	6	02-10-131	Bolt galvanized M12X35 (DIN 933)
7	2	02-02-030	O-ring Φ174x5.33mm for X & Y-6"
8	1	02-01-063	Lid for sand media filters X with hole
9	1	02-01-062	Lid for sand media filters X without hole with O-ring
10	1	02-05-342	Plug 1" TM (PE)
11	1	05-20-002	Air release valve 1" single acting
12	4	02-02-050	Rubber flange 1½" DIN (Φ60),2" ELOT
13	16	02-10-303	Nut DIN 934 - M16 x 2
14	16	02-10-200	Washer DIN 125 - A17 galvanized
15	16	02-10-379	Bolt galvanized M16x55 DIN 931
16	5	02-04-166	Hydraulic valve 1½" BSP
17	2	02-05-127	Union PVC Φ50 x 1½" Glued - TM
18	1	02-05-128	Elbow PVC solvent gluing d.50
19	1	00-02-209	Pipe PvC d 50/16 atm
20	1	02-05-129	Tee Φ50 PVC 90
21	2	02-07-056	In line filter 1/4" finger
22	2	02-05-010	Nipple 1/4"x 1/8"
23	2	02-04-004	Ball valve 1/4" F-F
24	1	02-04-006	Ball valve 1/2" TM-TF
25	1	02-05-150	Nipple galvanized ½"
26	1	02-07-057	In-line filter ½" bronze
27	1	02-05-117	Reducing socket ½"TM - 1/4"TF (PE)
28	1	02-05-019	Connector lock Φ8 x 1/4" TM
29	1	02-08-028	Mounting plate for control panel 300x350 (central)
30	6	02-10-207	Nut galvanized M8 DIN 934
31	6	02-10-202	Washer galvanized M8 DIN125
32	6	02-10-168	Bolt galvanized M8 x 20 DIN 933
33	1	02-08-026-1	Pressure gauge mount (DP + 2 x)
34	1	02-10-005	Solenoid support base 1_8 5x (T)
35	1	02-07-240	LOGOi8 Ether TDE Monitor
36	1	06-02-006	Pressure gauge differential (A20DP-K-15 1/8") 0-1 bar
37	2	06-02-016	Glycerin pressure gauge 0-16 panel mount
38	5	02-07-006	Solenoid tecnidro 1/8" 24V AC N.C.
39	10	02-10-140	Flat head screw 3.5x13 inox

02-17-152 Multi-media filter series WTX 1 1/2"-18" Auto

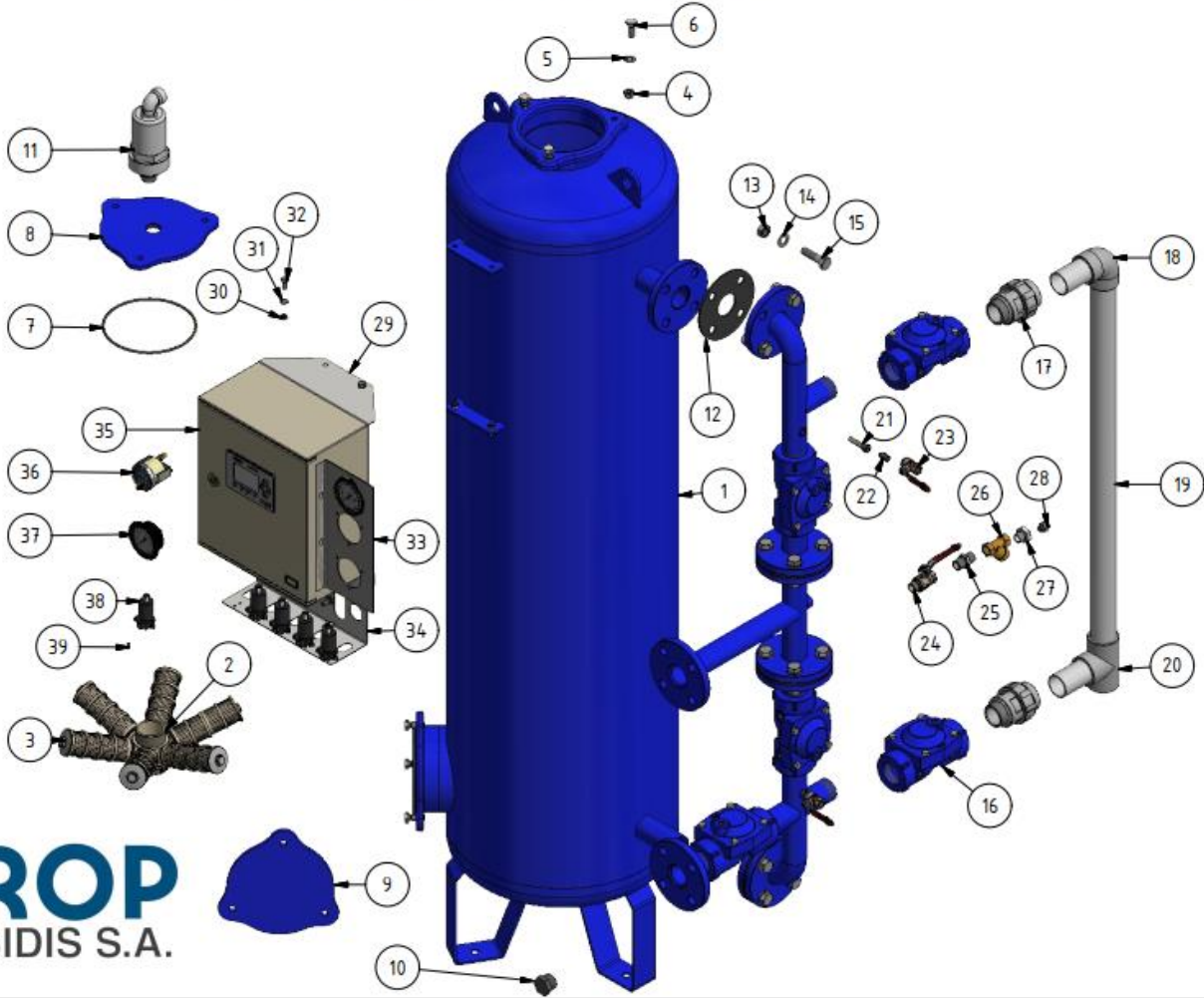

05-17-202A

ITEM	QTY	PART NUMBER	TITLE
1	1	02-00-837-20-000	Filter housing WTX 2"-24" (600*1500)
2	1	02-03-107	Collector 2" MS06 (PP)
3	6	02-03-110	Diffuser PP L 175xM30 slot 0.5 for filter X 2"-24"
4	6	02-10-306	Nut M12 galvanized
5	6	02-10-250	Washer M12 DIN 125
6	6	02-10-131	Bolt galvanized M12X35 (DIN 933)
7	2	02-02-030	O-ring Φ 174x5.33mm for X & Y-6"
8	1	02-01-062	Lid for sand media filters X
9	1	02-05-342	Plug 1" TM (PE)
10	1	05-20-002	Air release valve 1" single acting
11	6	02-02-051	Rubber flange 2" DIN (Φ 60),2" EL0T
12	24	02-10-303	Nut DIN 934 - M16 x 2
13	24	02-10-200	Washer DIN 125 - A17 galvanized
14	24	02-10-161	Bolt galvanized M16x60 DIN 931
15	2	02-04-197	Hydraulic valve 2" BSP
16	2	02-04-102	Main hydraulic valve 2" Technidro
17	2	02-05-208	Union PVC Φ 50 x 2" Glued - TM
18	1	02-05-012	Elbow PVC solvent gluing d.63
19	1	00-02-525	Pipe PvC d 63/16 atm
20	1	02-05-062	Tee Φ 63 PVC 90
21	2	02-07-056	In line filter 1/4" finger
22	2	02-05-010	Nipple 1/4"x 1/8"
23	2	02-04-004	Ball valve 1/4" F-F
24	1	02-05-016	Elbow galvanized 1/2" x 1/2" TM-TF
25	1	02-04-006	Ball valve 1/2" TM-TF
26	1	02-05-150	Nipple galvanized 1/2"
27	1	02-07-057	In-line filter 1/2" bronze
28	1	02-05-117	Reducing socket 1/2"TM - 1/4"TF galvanized
29	1	02-08-028	Mounting plate for control panel 300x350 (central)
30	6	02-10-207	Nut galvanized M8 DIN 934
31	6	02-10-202	Washer galvanized M8 DIN125
32	6	02-10-188	Bolt M8 X 16 DIN 933
33	1	02-08-026-1	Pressure gauge mount (DP + 2 x)
34	1	06-02-006	Pressure gauge differential (A20DP-K-15 1/8") 0-1 bar
35	2	06-02-016	Glycerin pressure gauge 0-16 panel mount
36	1	02-10-005	Solenoid support base 1_8 5x (T)
37	5	02-07-006	Solenoid tecnidro 1/8" 24V AC N.C.
38	10	02-10-140	Flat head screw 3.5x13 inox
39	1	02-07-240	LOGOi8 Ether TDE Monitor

05-17-202 Multi-media filter series WTX 2"-20" Auto

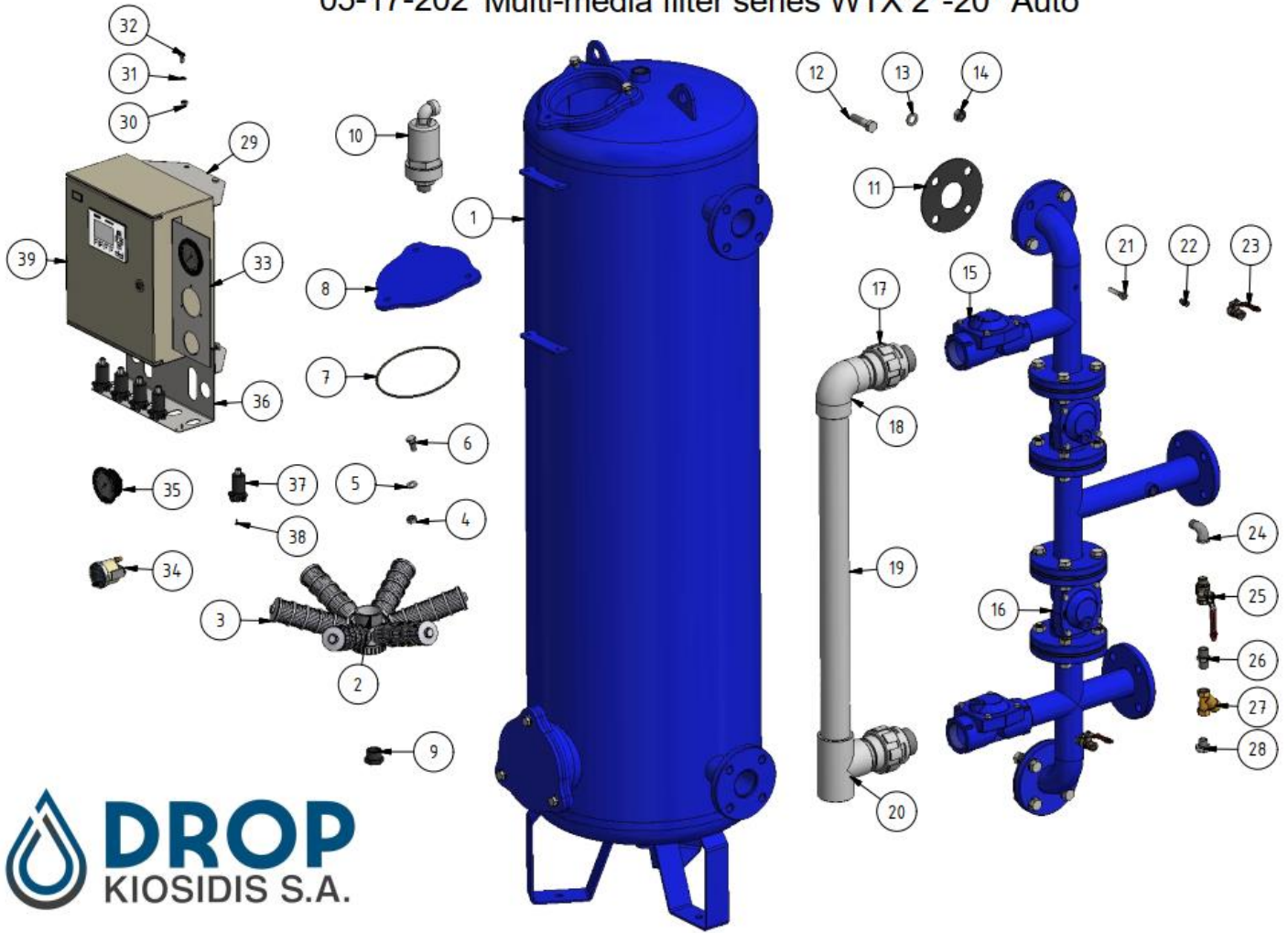

05-17-204A

ITEM	QTY	PART NUMBER	TITLE
1	1	02-00-838-24-002	Filter housing WTX 2"-24" (600*1500)
2	1	02-03-107	Collector 2" MS06 (PP)
3	6	02-03-110	Diffuser PP L 237xM30 slot 0.5 for filter X 2"-24"
4	6	02-10-306	Nut M12 galvanized
5	6	02-10-250	Washer M12 DIN 125
6	6	02-10-131	Bolt galvanized M12X35 (DIN 933)
7	2	02-02-030	O-ring Φ 174x5.33mm for X & Y-6"
8	1	02-01-062	Lid for sand media filters X
9	1	02-05-342	Plug 1" TM (PE)
10	1	05-20-002	Air release valve 1" single acting
11	6	02-02-051	Rubber flange 2" DIN (Φ 60),2" EL0T
12	24	02-10-303	Nut DIN 934 - M16 x 2
13	24	02-10-200	Washer DIN 125 - A17 galvanized
14	24	02-10-161	Bolt galvanized M16x60 DIN 931
15	2	02-04-197	Hydraulic valve 2" BSP
16	2	02-04-102	Main hydraulic valve 2" Technidro
17	2	02-05-208	Union PVC Φ 50 x 2" Glued - TM
18	1	02-05-128	Elbow PVC solvent gluing d.63
19	1	00-02-525	Pipe PvC d 63/16 atm
20	1	02-05-062	Tee Φ 63 PVC 90
21	2	02-07-056	In line filter 1/4" finger
22	2	02-05-010	Nipple 1/4"x 1/8"
23	2	02-04-004	Ball valve 1/4" F-F
24	1	02-05-016	Elbow galvanized 1/2" x 1/2" TM-TF
25	1	02-04-006	Ball valve 1/2" TM-TF
26	1	02-05-150	Nipple galvanized 1/2"
27	1	02-07-057	In-line filter 1/2" bronze
28	1	02-05-117	Reducing socket 1/2"TM - 1/4"TF galvanized
29	1	02-08-028	Mounting plate for control panel 300x350 (central)
30	6	02-10-207	Nut galvanized M8 DIN 934
31	6	02-10-202	Washer galvanized M8 DIN125
32	6	02-10-188	Bolt M8 X 16 DIN 933
33	1	02-08-026-1	Pressure gauge mount (DP + 2 x)
34	1	06-02-006	Pressure gauge differential (A20DP-K-15 1/8") 0-1 bar
35	2	06-02-016	Glycerin pressure gauge 0-16 panel mount
36	1	02-10-005	Solenoid support base 1_8 5x (T)
37	5	02-07-006	Solenoid tecnidro 1/8" 24V AC N.C.
38	10	02-10-140	Flat head screw 3.5x13 inox
39	1	02-07-240	LOGOi8 Ether TDE Monitor

05-17-204 Multi-media filter series WTX 2"-24 Auto

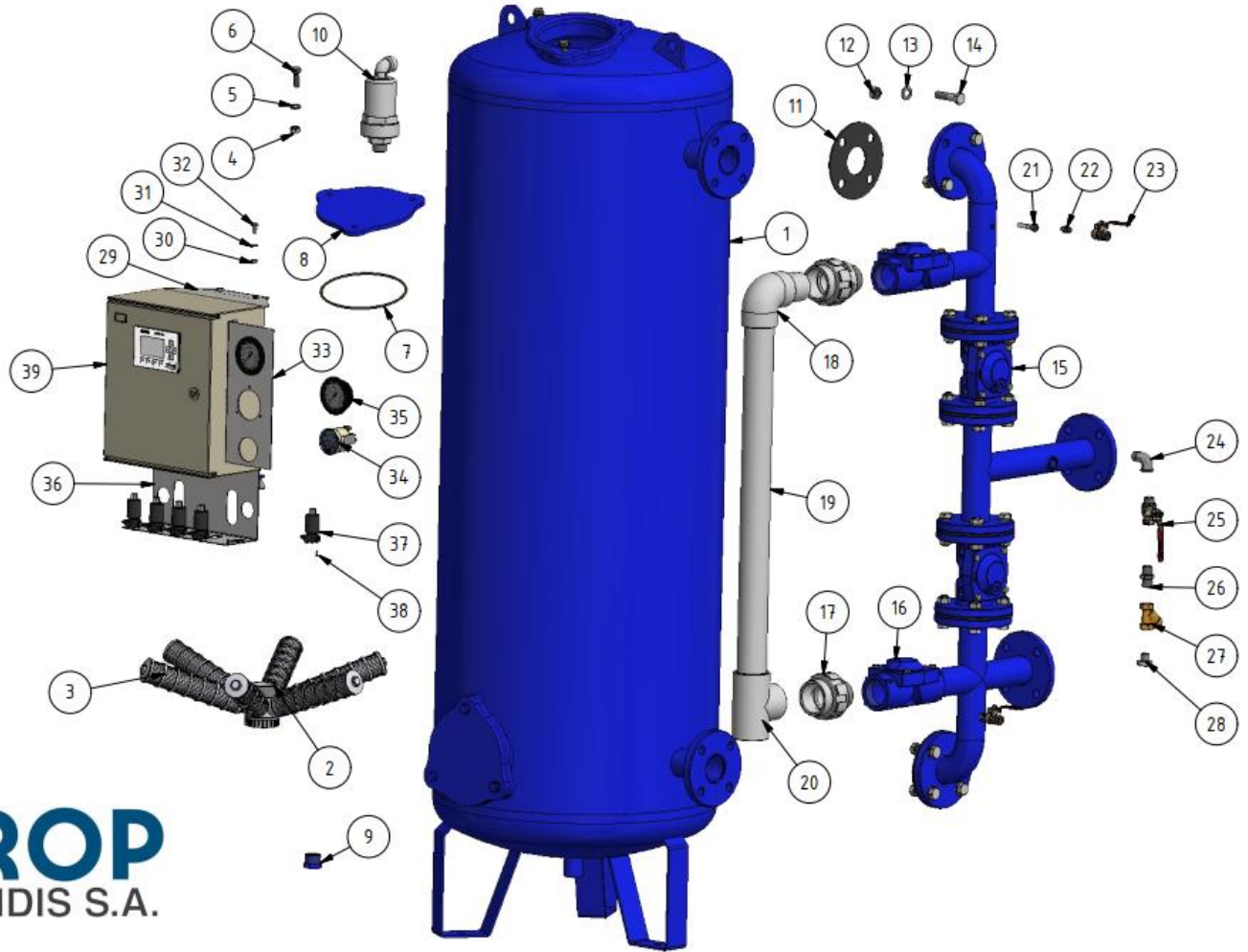

05-17-300A

ITEM	QTY	PART NUMBER	TITLE
1	1	02-00-839-30-000	Filter housing WTX 2"-30" (750*1500)
2	1	02-03-107	Collector 2" MS06 (PP)
3	6	02-03-161	Diffuser PP L 299xM30 slot 0.5 for filter X 2"-30"
4	6	02-10-306	Nut M12 galvanized
5	6	02-10-250	Washer M12 DIN 125
6	6	02-10-131	Bolt galvanized M12X35 (DIN 933)
7	2	02-02-030	O-ring Φ 174x5.33mm for X & Y-6"
8	2	02-01-062	Lid for sand media filters X
9	1	02-05-342	Plug 1" TM (PE)
10	1	05-20-002	Air release valve 1" single acting
11	6	02-02-051	Rubber flange 2" DIN (Φ 60),2" ELOT
12	24	02-10-303	Nut DIN 934 - M16
13	24	02-10-200	Washer DIN 125 - A17 galvanized
14	24	02-10-161	Bolt galvanized M16x60 DIN 931
15	2	02-04-197	Hydraulic valve 2" BSP
16	2	02-04-102	Main hydraulic valve 2" Technidro
17	2	02-05-208	Union PVC Φ 50 x 2" Glued - TM
18	1	02-05-128	Elbow PVC solvent gluing d.63
19	1	00-02-525	Pipe PvC d 63/16 atm
20	1	02-05-062	Tee Φ 63 PVC 90
21	2	02-07-056	In line filter 1/4" finger
22	2	02-05-010	Nipple 1/4"x 1/8"
23	2	02-04-004	Ball valve 1/4" F-F
24	1	02-05-016	Elbow galvanized 1/2" x 1/2" TM-TF
25	1	02-04-006	Ball valve 1/2" TM-TF
26	1	02-05-150	Nipple galvanized 1/2"
27	1	02-07-057	In-line filter 1/2" bronze
28	1	02-05-117	Reducing socket 1/2"TM - 1/4"TF galvanized
29	1	02-08-028	Mounting plate for control panel 300x350 (central)
30	6	02-10-207	Nut galvanized M8 DIN 934
31	6	02-10-202	Washer galvanized M8 DIN125
32	6	02-10-188	Bolt M8 X 16 DIN 933
33	1	02-08-026-1	Pressure gauge mount (DP + 2 x)
34	1	06-02-006	Pressure gauge differential (A20DP-K-15 1/8") 0-1 bar
35	2	06-02-016	Glycerin pressure gauge 0-16 panel mount
36	1	02-10-005	Solenoid support base 1_8 5x (T)
37	5	02-07-006	Solenoid tecnidro 1/8" 24V AC N.C.
38	10	02-10-140	Flat head screw 3.5x13 inox
39	1	02-07-240	LOGOi8 Ether TDE Monitor

05-17-300 Multi-media filter series WTX 2"-30" Auto

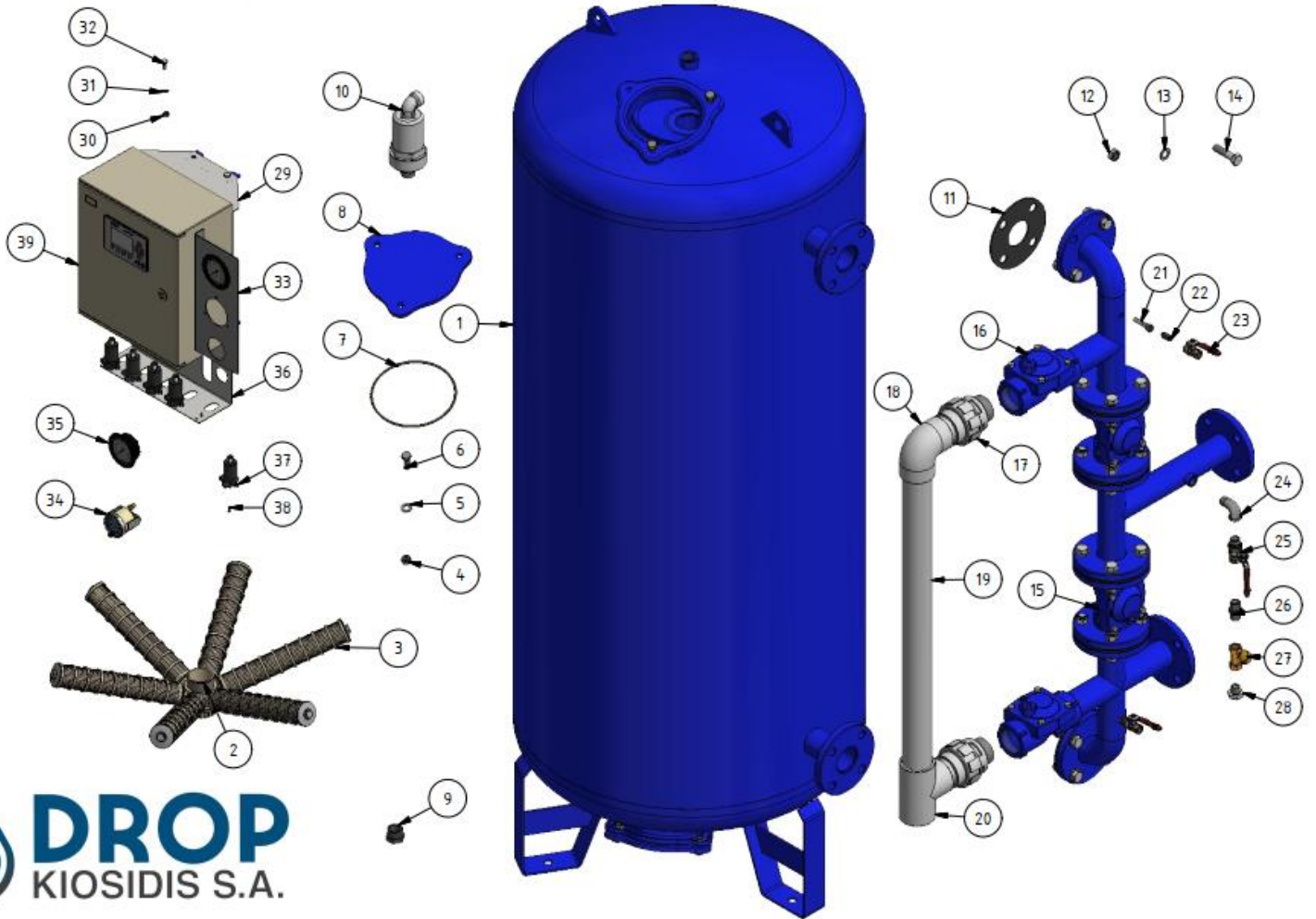

05-17-236A

ITEM	QTY	PART NUMBER	TITLE
1	1	02-00-840-36-200	Filter housing WTX 2'-36"
2	1	02-03-108	Collector 3" MS08 (PP)
3	8	02-03-111	Diffuser PP L 361xM30 slot 0.5 for filter X-2'-36"
4	4	02-10-303	Nut M16 galvanized
5	4	02-10-200	Washer M16 galvanized
6	4	02-10-114	Bolt galvanized hexagon M16x100
7	1	02-02-019	Lid for seal O, K 5'-6" (RBR), S 5'-6", C 6", SY 6"
8	1	03-01-086	Manhole 10" lid w.o. hole
9	3	02-10-306	Nut M12 galvanized DIN934
10	3	02-10-250	Washer M12 DIN 125
11	3	02-10-131	Bolt galvanized M 12x35 DIN 24017
12	1	02-02-030	O-ring d. 174x 5.33mm for lid X
13	1	02-01-062	Lid for sand media filters X without hole with O-ring
14	1	02-05-342	Plug 1" TM (PE)
15	1	05-20-002	Air release valve 1" single acting
16	7	02-02-051	Rubber flange 2" DIN (Φ60), 2" EL0T
17	28	02-10-303	Nut DIN 934 - M16 x 2
18	28	02-10-200	Washer DIN 125 - A17 galvanized
19	28	02-10-161	Bolt galvanized M16x60 DIN 931
20	2	02-04-102	2way hydraulic valve Tecnidro 2" TM-TM BSP
21	3	02-04-197	2way hydraulic valve Tecnidro 2" flanged
22	2	02-05-208	Union PVC Φ63 x 2" Glued - TM
23	1	02-05-012	Elbow solvent gluing PVC d.63
24	1	00-02-500	Pipe PvC d 63/16 atm
25	1	02-05-062	Tee PVC d.63 solvent gluing
26	2	02-07-056	In line filter 1/4" finger
27	2	02-05-010	Nipple 1/4"x 1/8"
28	2	02-04-004	Ball valve 1/4" F-F
29	1	02-05-016	Elbow galvanized 1/2" x 1/2" TM-TF
30	1	02-04-006	Ball valve 1/2" TM-TF
31	1	02-05-150	Nipple galvanized 1/2"
32	1	02-07-057	In-line filter 1/2" bronze
33	1	02-05-117	Reducing socket 1/2"TM - 1/4"TF (PE)
34	1	02-08-028	Mounting plate for control panel 300x350 (central)
35	4	02-10-207	Nut galvanized M8 DIN 934
36	4	02-10-202	Washer galvanized M8 DIN125
37	4	02-10-168	Bolt galvanized M8 x 20 DIN 933
38	1	02-08-026-1	Pressure gauge mount (DP + 2 x)
39	1	06-02-006	Pressure gauge differential (A20DP-K-15 1/8") 0-1 bar
40	2	06-02-016	Glycerin pressure gauge 0-16 panel mount
41	1	02-10-005	Solenoid support base 1_8 5x (T)
42	5	02-07-005	Solenoid tecnidro 1/8" 24V AC N.O.
43	10	02-10-140	Flat head screw 3.5x13 inox
44	1	02-07-240	LOGOi8 Ether TDE Monitor

02-17-236 Multi-media filter series WTX 2"-36" Auto

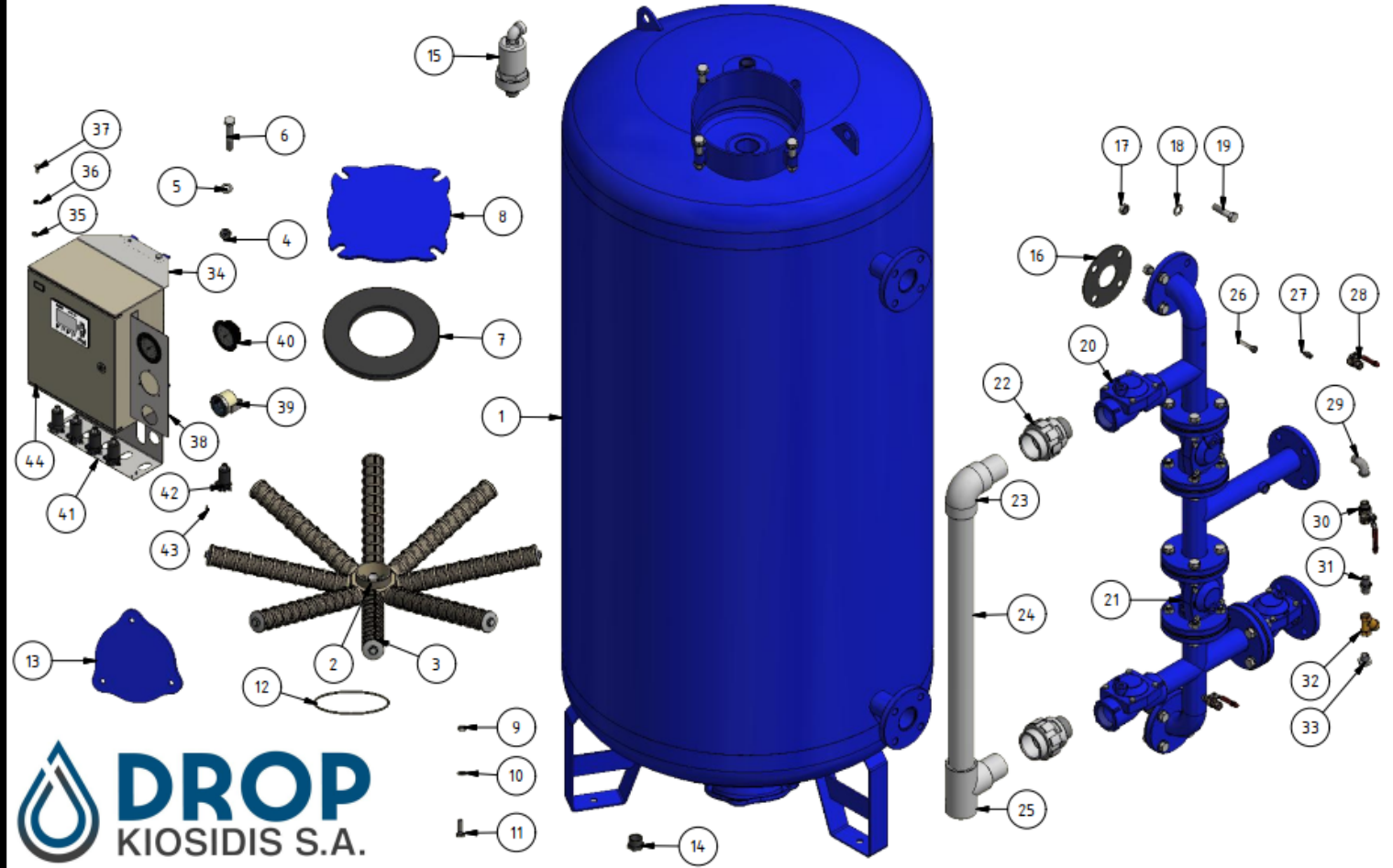

 **DROP**
KIOSIDIS S.A.

05-17-238A

ITEM	QTY	PART NUMBER	TITLE
1	1	02-00-840-36-200	Filter housing WTX 3 "-36"
2	1	02-03-108	Collector 3" MS08 (PP)
3	8	02-03-111	Diffuser PP L 361xM30 slot 0.5 for filter X-3"-36"
4	4	02-10-303	Nut M16 galvanized
5	4	02-10-200	Washer M16 galvanized
6	4	02-10-114	Bolt galvanized hexagon M16x100
7	1	02-02-019	Lid for seal O, K 5"-6" (RBR), S 5"-6", C 6", SY 6"
8	1	03-01-086	Manhole 10" lid w.o. hole
9	3	02-10-306	Nut M12 galvanized DIN934
10	3	02-10-250	Washer M12 DIN 125
11	3	02-10-131	Bolt galvanized M 12x35 DIN 24017
12	1	02-02-030	O-ring d. 174x 5.33mm for lid X
13	1	02-01-062	Lid for sand media filters X without hole with O-ring
14	1	02-05-342	Plug 1" TM (PE)
15	1	05-20-002	Air release valve 1" single acting
16	7	02-02-056	Rubber flange 3" DIN (Φ60),2" ELOT
17	56	02-10-303	Nut DIN 934 - M16 x 2
18	56	02-10-200	Washer DIN 125 - A17 galvanized
19	56	02-10-379	Bolt galvanized M16x655 DIN 931
20	2	02-04-189	2way hydraulic valve Tecnidro 3" TM-TM BSP
21	2	02-04-133	2way hydraulic valve Tecnidro 3" flanged
22	2	02-05-209	Union PVC Φ63 x 3" Glued - TM
23	1	02-05-207	Elbow solvent gluing PVC d.90
24	1	05-08-522-02-01	Pipe PvC d 90/16 atm
25	1	02-05-060	Tee PVC d.90 solvent gluing
26	2	02-07-056	In line filter 1/4" finger
27	2	02-05-010	Nipple 1/4"x 1/8"
28	2	02-04-004	Ball valve 1/4" F-F
29	1	02-05-016	Elbow galvanized ½" x ½" TM-TF
30	1	02-04-006	Ball valve 1/2" TM-TF
31	1	02-05-150	Nipple galvanized ½"
32	1	02-07-057	In-line filter ½" bronze
33	1	02-05-117	Reducing socket ½"TM - 1/4"TF (PE)
34	1	02-08-028	Mounting plate for control panel 300x350 (central)
35	4	02-10-207	Nut galvanized M8 DIN 934
36	4	02-10-202	Washer galvanized M8 DIN125
37	4	02-10-168	Bolt galvanized M8 x 20 DIN 933
38	1	02-08-026-1	Pressure gauge mount (DP + 2 x)
39	1	06-02-006	Pressure gauge differential (A20DP-K-15 1/8") 0-1 bar
40	2	06-02-016	Glycerin pressure gauge 0-16 panel mount
41	1	02-10-005	Solenoid support base 1_8 5x (T)
42	5	02-07-005	Solenoid tecnidro 1/8" 24V AC N.O.
43	10	02-10-140	Flat head screw 3.5x13 inox
44	1	02-07-240	LOGOi8 Ether TDE Monitor

05-17-338A Multi-media filter series WTX 3"-36" Auto

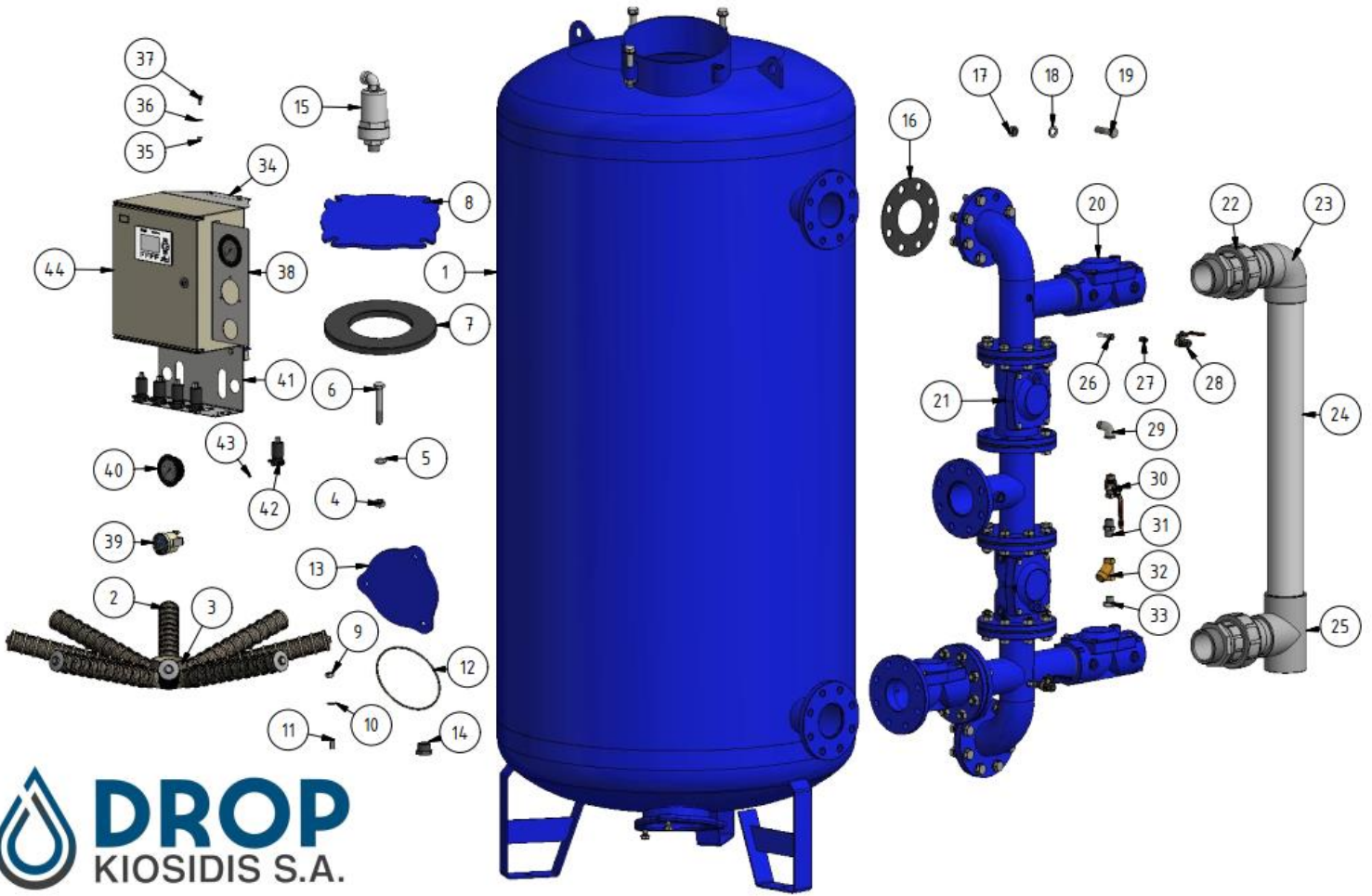

05-17-483A

ITEM	QTY	PART NUMBER	TITLE
1	1	02-00-842-48-006	Filter housing WTX 3" - 48"
2	1	02-03-108	Collector 3" MS08 (PP)
3	8	02-03-112	Diffuser PP L 516xM30 slot 0.5 for filter WT(X)-2"/3"-48"
4	4	02-10-303	Nut M16 galvanized
5	4	02-10-200	Washer M16 galvanized
6	4	02-10-114	Bolt galvanized hexagon M16x100
7	1	02-02-019	Lid for seal O, K 5"-6" (RBR), S 5"-6", C 6", SY 6"
8	1	03-01-086	Manhole 10" lid w.o. hole
9	4	02-10-306	Nut M12 galvanized DIN934
10	4	02-10-250	Washer M12 DIN 125
11	4	02-10-148	Bolt galvanized M 12x75 DIN 24017
12	1	02-02-063	Seal for lid X 48"
13	1	02-01-087	Lid for sand media filters X with hole
14	1	02-04-007	Ball valve 1" TM-TF
15	1	05-20-002	Air release valve 1" single acting
16	6	02-02-056	Rubber flange 3" DIN (Φ60), 2" ELOT
17	48	02-10-303	Nut DIN 934 - M16 x 2
18	48	02-10-200	Washer DIN 125 - A17 galvanized
19	48	02-10-379	Bolt galvanized M16x55 DIN 931
20	2	02-04-189	2way hydraulic valve Tecnidro 3" TM-TM BSP
21	3	02-04-133	2way hydraulic valve Tecnidro 3" flanged
22	2	02-05-209	Union PVC Φ90 x 3" Glued - TM
23	1	02-05-207	Elbow solvent gluing PVC d.90
24	1	05-08-522-01	Pipe PvC d 90/16 atm
25	1	02-05-060	Tee PVC d.90 solvent gluing
26	2	02-07-056	In line filter 1/4" finger
27	2	02-05-010	Nipple 1/4"x 1/8"
28	2	02-04-004	Ball valve 1/4" F-F
29	1	02-05-016	Elbow galvanized 1/2" x 1/2" TM-TF
30	1	02-04-006	Ball valve 1/2" TM-TF
31	1	02-05-150	Nipple galvanized 1/2"
32	1	02-07-057	In-line filter 1/2" bronze
33	1	02-05-117	Reducing socket 1/2"TM - 1/4"TF (PE)
34	1	02-08-028	Mounting plate for control panel 300x350 (central)
35	6	02-10-207	Nut galvanized M8 DIN 934
36	6	02-10-202	Washer galvanized M8 DIN125
37	6	02-10-168	Bolt galvanized M8 x 20 DIN 933
38	1	02-08-026-1	Pressure gauge mount (DP + 2 x)
39	1	06-02-006	Pressure gauge differential (A20DP-K-15 1/8") 0-1 bar
40	2	06-02-016	Glycerin pressure gauge 0-16 panel mount
41	1	02-10-005	Solenoid support base 1_8 5x (T)
42	5	02-07-005	Solenoid tecnidro 1/8" 24V AC N.O.
43	10	02-10-140	Flat head screw 3.5x13 inox
44	1	02-07-240	LOGi8 Ether TDE Monitor

05-17-483 Multi-media filters series WTX 3"-48" Auto



05-17-480A

ITEM	QTY	PART NUMBER	TITLE
1	1	02-00-842-48-009	Filter housing WTX 2'-48"
2	1	02-03-108	Collector 3" MS08 (PP)
3	8	02-03-112	Diffuser PP L 516xM30 slot 0.5 for filter X-2'-48"
4	4	02-10-303	Nut M16 galvanized
5	4	02-10-200	Washer M16 galvanized
6	4	02-10-114	Bolt galvanized hexagon M16x100
7	1	02-02-019	Lid for seal O, K 5'-6" (RBR), S 5'-6", C 6", SY 6"
8	1	03-01-086	Manhole 10" lid w.o. hole
9	4	02-10-306	Nut M12 galvanized DIN934
10	4	02-10-250	Washer M12 DIN 125
11	4	02-10-148	Bolt galvanized M 12x75 DIN 24017
12	1	02-02-063	Seal for lid X 48"
13	1	02-01-087	Lid for sand media filters X with hole
14	1	02-04-007	Ball valve 1" TM-TF
15	1	05-20-002	Air release valve 1" single acting
16	7	02-02-051	Rubber flange 2" DIN (Φ60), 2" ELOT
17	28	02-10-303	Nut DIN 934 - M16 x 2
18	28	02-10-200	Washer DIN 125 - A17 galvanized
19	28	02-10-161	Bolt galvanized M16x60 DIN 931
20	2	02-04-102	2way hydraulic valve Tecnidro 2" TM-TM BSP
21	3	02-04-197	2way hydraulic valve Tecnidro 2" flanged
22	2	02-05-208	Union PVC Φ63 x 2" Glued - TM
23	1	02-05-012	Elbow solvent gluing PVC d.63
24	1	00-02-500	Pipe PvC d 63/16 atm
25	1	02-05-062	Tee PVC d.63 solvent gluing
26	2	02-07-056	In line filter 1/4" finger
27	2	02-05-010	Nipple 1/4"x 1/8"
28	2	02-04-004	Ball valve 1/4" F-F
29	1	02-05-016	Elbow galvanized 1/2" x 1/2" TM-TF
30	1	02-04-006	Ball valve 1/2" TM-TF
31	1	02-05-150	Nipple galvanized 1/2"
32	1	02-07-057	In-line filter 1/2" bronze
33	1	02-05-117	Reducing socket 1/2"TM - 1/4"TF (PE)
34	1	02-08-028	Mounting plate for control panel 300x350 (central)
35	6	02-10-207	Nut galvanized M8 DIN 934
36	6	02-10-202	Washer galvanized M8 DIN125
37	6	02-10-168	Bolt galvanized M8 x 20 DIN 933
38	1	02-08-026-1	Pressure gauge mount (DP + 2 x)
39	1	06-02-006	Pressure gauge differential (A20DP-K-15 1/8") 0-1 bar
40	2	06-02-016	Glycerin pressure gauge 0-16 panel mount
41	1	02-10-005	Solenoid support base 1_8 5x (T)
42	5	02-07-005	Solenoid tecnidro 1/8" 24V AC N.O.
43	10	02-10-140	Flat head screw 3.5x13 inox
44	1	02-07-240	LOGOi8 Ether TDE Monitor

05-17-480 Multi-media filter series WTX 2"-48" Auto

